

Roof Axial Supply/Exhaust Fans



Available in a wide range of airflows to suit most applications.

Common Applications

- Sizes from 560 - 1000mm

Features

- Available in a wide range of speeds
- Vertical metal
- Down flow covers plastic
- Performance tests are in accordance with ISO5801 (2017)
- Noise level tests are under BS848 Part 2 (1985) and DIN 45635 Part 38

Options

- Exe & smokespill & H Class
- Metal, PPG, Nylon or anti static blades
- Painting or colour matching optional extra

Order Code

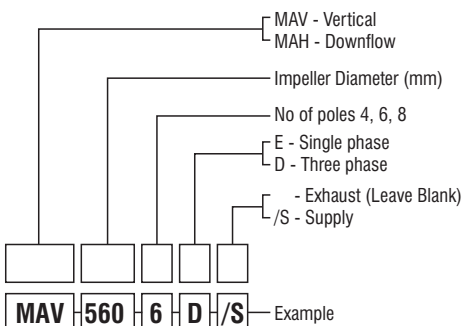

MAV, MAH & MAH/S Series

4 Pole

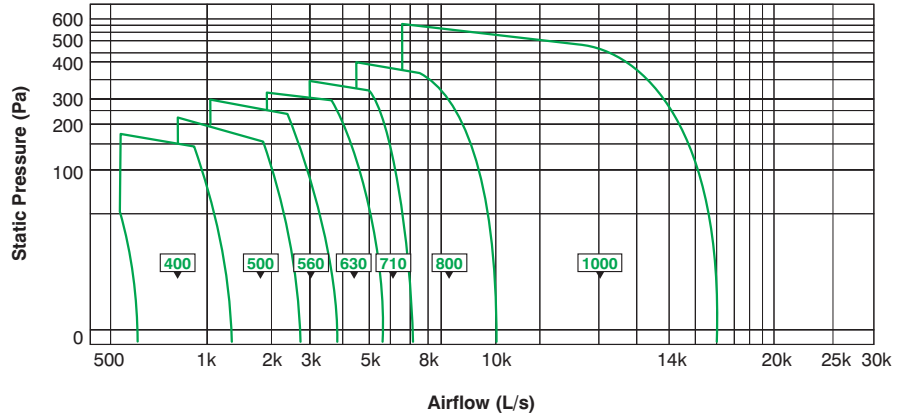

6 Pole

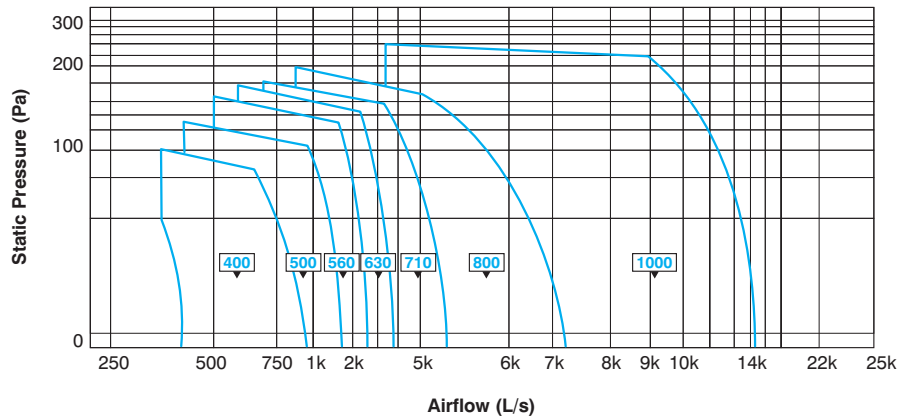

8 Pole

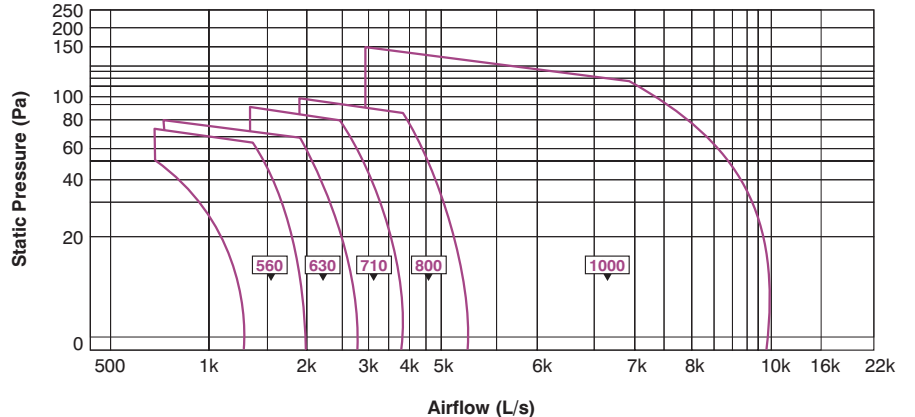

Please Note: Performance graphs are of a general nature due to various possible impeller configurations. Contact your local representative for specific data selection.

Roof Axial Supply/Exhaust Fans

Technical Data

■ 4 POLE ■ 6 POLE ■ 8 POLE

Model	Speed r/s	Motor Kw		Motor Amps		SPL dB(A) @3m
		Min	Max	Min	Max	
MAV/MAH560/4	24	0.37	2.20	1.10	4.90	64
MAV/MAH560/6	16	0.18	0.75	0.84	2.40	59
MAV/MAH560/8	12	0.18	0.55	0.95	2.15	51
MAV/MAH630/4	24	0.37	3.00	1.10	6.50	66
MAV/MAH630/6	16	0.18	1.10	0.84	3.10	64
MAV/MAH630/8	12	0.18	0.55	0.85	2.15	57
MAV/MAH710/4	24	0.75	4.00	1.95	8.40	70
MAV/MAH710/6	16	0.37	2.20	1.35	5.90	66
MAV/MAH710/8	12	0.18	0.75	0.95	2.40	59
MAV/MAH800/4	24	1.10	7.50	3.00	14.60	74
MAV/MAH800/6	16	0.37	2.20	1.35	5.90	69
MAV/MAH800/8	12	0.18	1.10	0.95	3.40	62
MAV/MAH1000/4	24	2.20	7.50	4.90	14.60	83
MAV/MAH1000/6	16	0.55	5.50	1.65	12.80	75
MAV/MAH1000/8	12	0.37	3.00	1.70	8.40	68

Note: Contact CFM Airsystems for specifications notes. Amperages shown are a guide only.

Technical Data

Model	Kg	A	B	C	D	E	F
MAV560	85	626	615	715	355	80	450
MAV630	90	686	695	795	425	80	520
MAV710	100	776	740	840	435	80	530
MAV800	TBA	816	810	960	555	80	650
MAV1000	TBA	1034	1010	1160	585	80	680

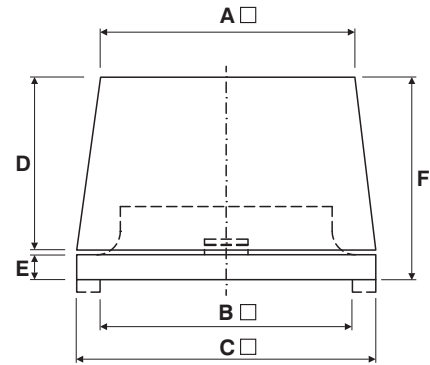

Technical Data

Model	Kg	A	B	C	D	E
MAH560	85	800	615	715	80	500
MAH630	90	960	695	795	80	545
MAH710	100	1200	740	840	80	585
MAH800	TBA	1230	810	960	80	670
MAH1000	TBA	1410	1010	1160	80	710

Note: Please note the above information applies to MAH & MAH/S.

